



# Rovatti FL3-101GA Series Flange Pump

SAE 3

01/2002

Itemized Part Listing

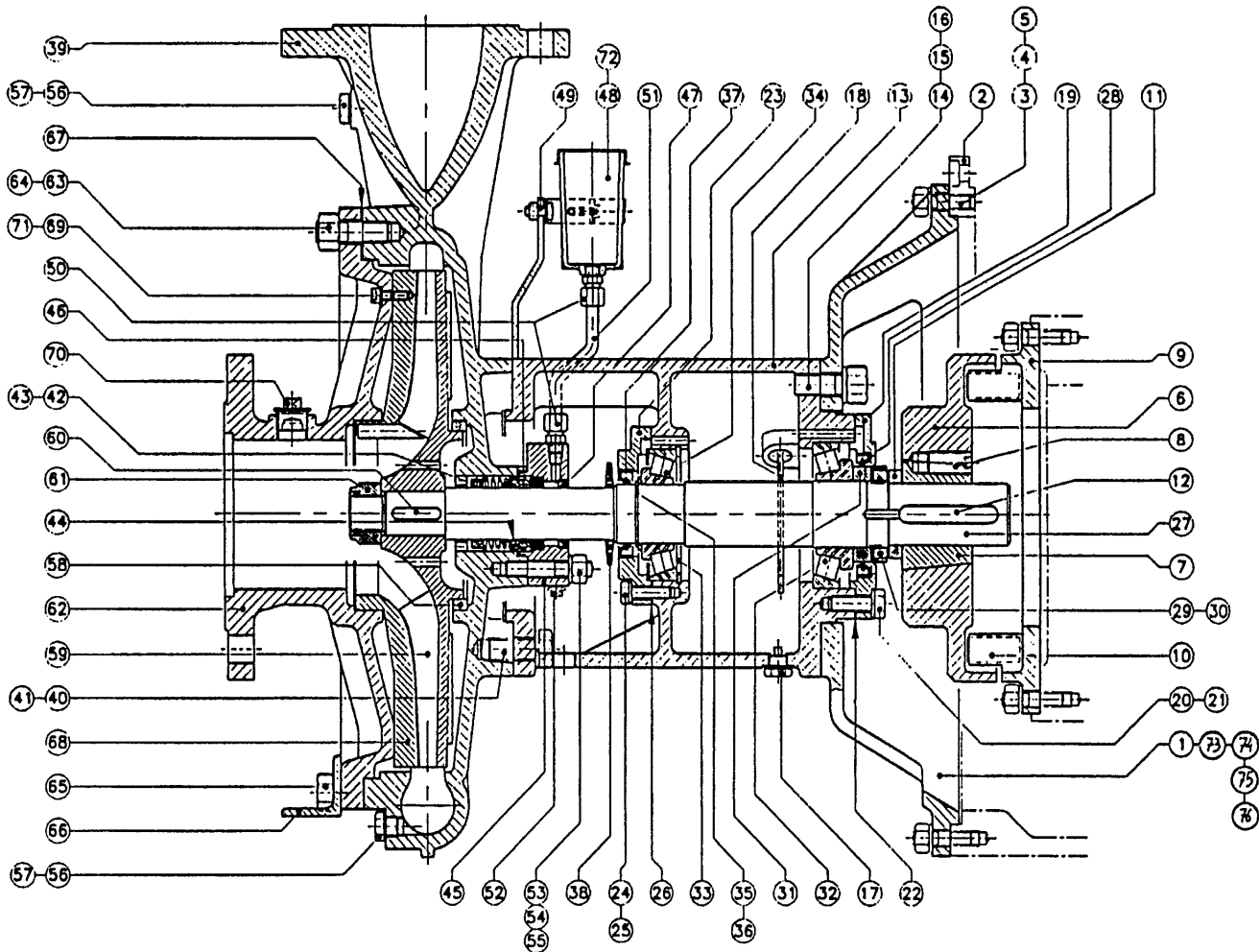

NOTE: See serial plate located on pump for ratio to indicate parts needed for POS 6, 11 and 44.

**Place "RI" prefix before all part numbers before placing orders**

POS	Item Description	FL3-101GA		FL3-101GA	
		Part #	Q	Part #	Q
		Mechanical Seal		Packing Rings	
1	Flange	8211	1	8211	1
2	Ring	****	**	****	**
3	Bolt / Stud	****	**	****	**
4	Nut	****	**	****	**
5	Washer	****	**	****	**
6	Coupling / 8"	8334	1	8334	1
6	Coupling / 10"	8334	1	8334	1
6	Coupling / 11-1/2"	8335	1	8335	1
7	Bushing / Taper	8337	1	8337	1
8	Bolt	VCE16	2	VCE16	2
9	Flywheel / 8"	8329	1	8329	1
9	Flywheel / 10"	8330	1	8330	1
9	Flywheel / 11-1/2"	8331	1	8331	1
10	Pad / Rubber *	8310	9	8310	9
11	Ring / Coupling Spacing / 8"	8339	1	8339	1
11	Ring / Coupling Spacing / 10"	****	**	****	**
11	Ring / Coupling Spacing / 11-1/2"	****	**	****	**
12	Key	LI39	1	LI39	1
13	Support / Bearing	12197	1	12197	1
14	Bolt / Stud	VP21	4	VP21	4
15	Nut	DEA14	4	DEA14	4

Place "RI" prefix before all part numbers before placing orders

POS	Item Description	FL3-101GA		FL3-101GA	
		Part #	Q	Part #	Q
		Mechanical Seal		Packing Rings	
16	Washer	RE14	4	RE14	4
17	Plug / Magnetic	4470	1	4470	1
18	Plug / Breather (w/ Dipstick)	7216	1	7216	1
19	Cover	12200	1	12200	1
20	Bolt	VTE4	4	VTE4	4
21	Washer	RE10	4	RE10	4
22	Gasket *	4008	1	4008	1
23	Cover	12201	1	12201	1
24	Bolt	VTE8	4	VTE8	4
25	Washer	RE8	4	RE8	4
26	Gasket *	7092	1	7092	1
27	Shaft	12198	1	12198	1
28	Seal / Oil *	AT22	1	AT22	1
29	Nut / Self Locking Ring	NO178	1	NO178	1
30	Rosette	NO179	1	NO179	1
31	Ring	12202	1	12202	1
32	Bearing *	CU96	1	CU96	1
33	Circlip / Internal	AFI9	1	AFI9	1
34	Bearing *	CU100	1	CU100	1
35	Washer	RR18	1	RR18	1
36	Circlip / External	AFE7	1	AFE7	1
37	Seal / Oil *	AT8a	1	AT8a	1
38	Ring / Water Sealing	AP4	1	AP4	1
39	Body / Pump	9612	1	13012	1
40	Bolt	VTE41	4		
41	Washer	RE14	4		
42	Ring	8700	1	7223	1
43	Rollpin	VCE18	1	****	**
44	Seal / Mechanical *	TM35V	1	****	**
44	Ring / Packing *	****	**	6420	4
45	Cover	8699	1	1034	1
46	O-Ring *	OR41	1	****	**
47	Seal / Oil *	AT18	1	****	**
48	Oiler	12550	1	13018	1
49	Guard / Oiler	****	**	****	**
50	Fitting	****	**	****	**
51	Tube / Oiler	****	**	****	**
52	Plug	NO140	1	****	**
53	Bolt / Stud	VP7	2	VP5T	2
54	Nut	DEA10	2	DEA10T	2
55	Washer	RE10	2	****	**
56	Plug	NO19	2	NO19	2
57	Washer	RA4	2	RA4	2
58	Ring / Wear *	3686	1	3686	1
59	Impeller	9944	1	9944	1
60	Key	LI12	1	LI12	1
61	Nut / Impeller	DA24b	1	DA24b	1
62	Cover / Suction	12270	1	12270	1
63	Bolt / Stud	VP21	10	VP21	10
64	Nut	DEA14	8	DEA14	8
65	Nut	DEM14	2	DEM14	2
66	Foot / Support	3762	1	3762	1
67	Gasket *	9616	3	9616	3
68	Plate / Wear *	12286	1	12286	1
69	Bolt	VTCEI44	4	VTCEI44	4
70	Plug	NO14	1	NO14	1
71	Washer	NO188	4	NO188	4
72	Plug / Oiler	****	**	****	**
73	Guard / Protection	12446	1	12446	1
74	Bolt	VTE1c	3	VTE1c	3
75	Washer	RP1	3	RP1	3
76	Nut	DEA6	3	DEA6	3
77	O-Ring *	OR57	1	OR57	1

It is useful to keep a stock of fast wearing parts on hand for quick repairs. Most recommended spare parts are marked by an asterisk (\*) following part description.

**1-800-Team ABI**



Email [abigausa@att.net](mailto:abigausa@att.net)  
[www.abi-irrigation.com](http://www.abi-irrigation.com)



fl3-101ga.doc ABI 2003

**AgriBusiness International, Inc**  
P.O. Box 909  
Villa Rica, Georgia 30180 USA  
Ph. 770-459-4401 Fx. 770-459-6877