

Rovatti SLE Series Pump

Itemized Part Listing

11/2002

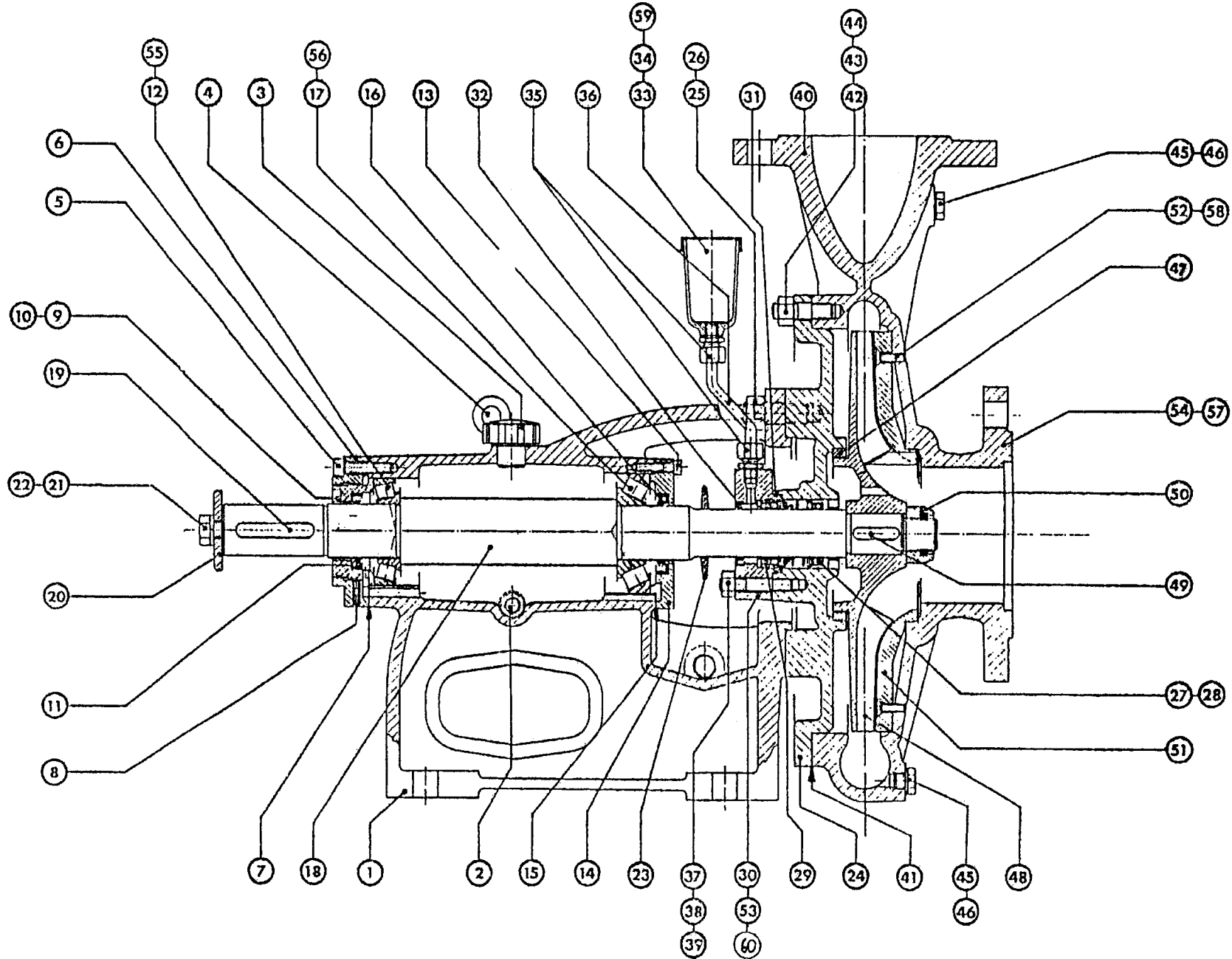

Place "RI" prefix before all part numbers before placing orders.

POS	Item Description	SLE2-85GA		SLE3-80GA	
		Part #	Q	Part #	Q
1	Support / Bearing	3331	1	9435	1
2	Plug / Magnetic	4470	1	4470	1
3	Plug / Breather	3370	1	3370	1
4	Dipstick / Oil Level *	3325	1	3405	1
5	Bolt	VTCEI1	3	VTCEI7	4
6	Cover	9494	1	9437	1
7	Gasket *	3340	1	3355	1
8	Screw / Set	VCEI8	1	VCEI8	1
9	Nut / Ring	9495	1	9467	1
10	O-Ring *	OR37	1	OR41	1
11	Seal / Oil *	AT31	1	AT8	1
12	Bearing *	CU85	1	CU92	1
13	Bolt	VTCEI20	3	VTCEI34	6
14	Cover	3334	1	9433	1
15	Gasket *	3340	1	9438	1
16	Seal / Oil *	AT5	1	AT8a	1
17	Bearing *	CU85	1	CU48	1
18	Shaft *	9493	1	9454	1
19	Key	LI12a	1	LI15	1
20	Washer	1705	1	4781	1
21	Bolt	VTE4	1	VTE7	1
22	Washer	RE10	1	RE12	1
23	Ring / Water Sealing *	AP2	1	AP5	1
24	Support / Pump	9492	1	9453	1
25	Bolt	VTE7	4	VTE41	4
26	Washer	****	**	RE14	4
27	Ring / Brass *	8668	1	8700	1
28	Screw / Set	VCEI8	1	VCEI8	1
29	Seal / Mechanical *	TM25V	1	TM35V	1
30	Cover	8670	1	8699	1
31	O-Ring *	OR37	1	OR41	1
32	Seal / Oil *	AT16	1	AT18	1
33	Reservoir / Oil	NO89	1	NO89	1
34	Bracket / Oiler	****	**	****	**
35	Connection / Oiler Tube	****	**	****	**
36	Tube / Oiler	****	**	****	**
37	Bolt / Stud	VP2	2	VP7	2
38	Nut	DEA8	2	DEA10	2
39	Washer	****	**	RE10	2
40	Body / Pump	12271	1	12269	1
41	Gasket *	3855	3	3100	3
42	Bolt / Stud	VP3	8	VP3	8
43	Nut	DEA10	8	DEA10	8
44	Washer	****	**	****	**
45	Plug	NO19	2	NO19	2
46	Washer	RA4	2	RA4	2
47	Ring / Wear *	****	**	****	**
48	Impeller *	9928	1	12098	1
49	Key	LI20	1	LI20	1
50	Nut / Impeller *	DA16b	1	DA20b	1
51	Plate / Wear *	12283	1	12284	1
52	Bolt	VTCEI43	4	VTCEI43	4
53	Plug	NO140	1	NO140	1
54	Cover / Aspiration	****	**	****	**
55	Washer	****	**	RS19	2
56	Washer	****	**	RS19	2
57	Plug	NO14	1	NO14	1
58	Washer	NO174	4	NO174	4
59	Cap / Oil Reservoir	****	**	****	**
60	Screw / Set	VCE7	1	VCE7	1

It is useful to keep a stock of fast wearing parts on hand for quick repairs. Most recommended spare parts are marked by an asterisk (*) following part description.

1-800-Team ABI

Email abigausa@att.net
www.abi-irrigation.com

sle.pdf ABI 2002



AgriBusiness International, Inc
P.O. Box 909
Villa Rica, Georgia 30180 USA
Ph. 770-459-4401 Fx. 770-459-6877