

Rovatti TC Series Chopper

Itemized Part Listing

11/2002

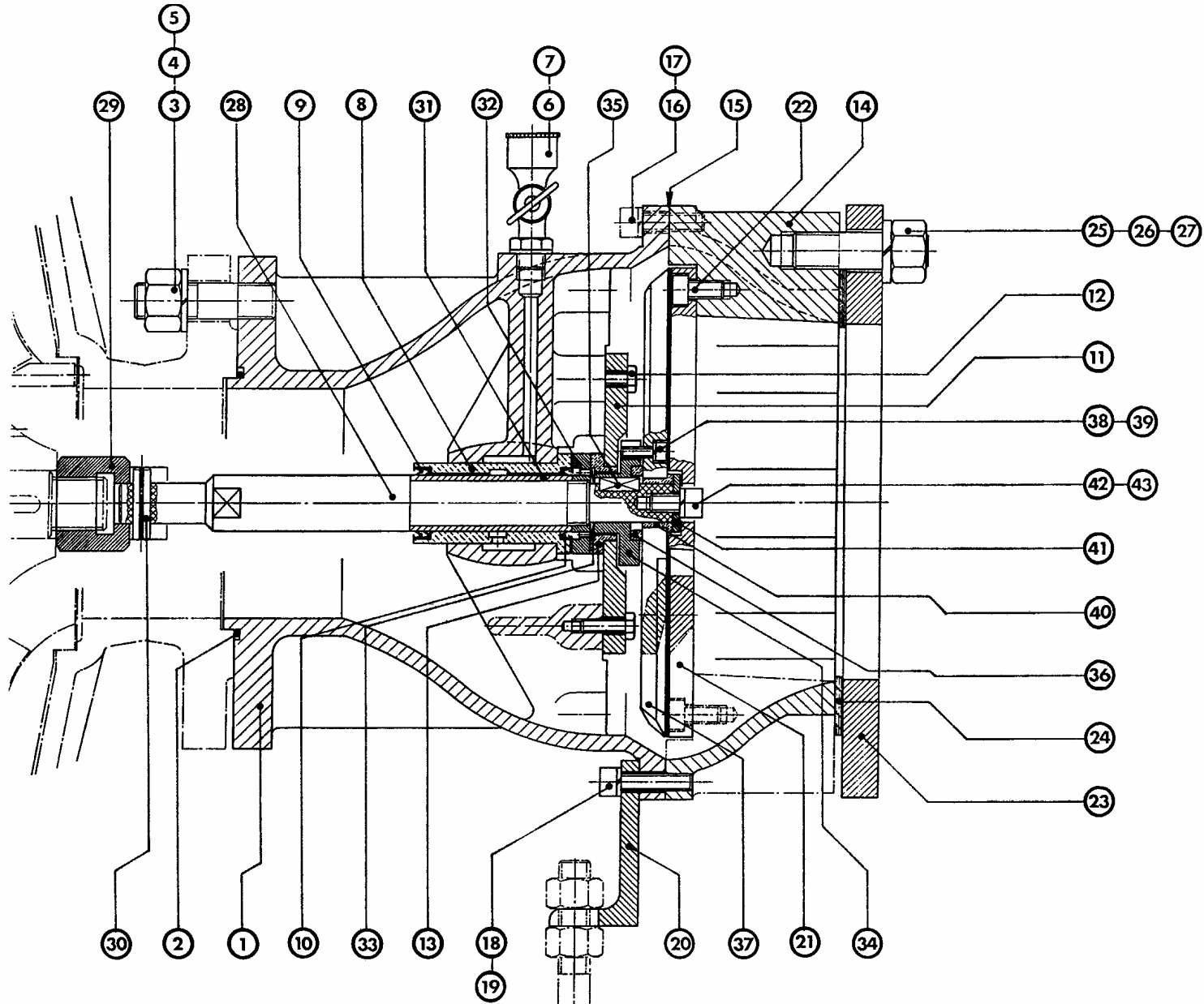

Place "RI" prefix before all part numbers before placing orders.

POS	Item Description	TC 80		TC 100	
		Part #	Q	Part #	Q
1	Body/Chopper	9559	1	9560	1
2	O-Ring *	OR46	1	OR45	1
3	Bolt-Stud	VP25	4	VP25	8
4	Nut	DEA16	4	DEA16	8
5	Washer	RE16	4	RE16	8
6	Fitting /Grease	NO7	1	NO7	1
7	Washer	RA4	1	RA4	1
8	Bearing *	9563	1	9563	1
9	Seal / Oil *	AT34	2	AT34	2
10	Seal / Oil *	AT34	1	AT34	1
11	Support	9567	1	9567	1
12	Bolt	VTE77	2	VTE77	1
13	Bearing *	9562	1	9562	1
14	Cover	9561	1	9561	1
15	Gasket *	9050	1	9050	1
16	Bolt	VTCEI24	6	VTCEI24	6
17	Washer	RE8	6	RE8	6
18	Bolt / Shear *	VTCEI7	2	VTCEI7	2
19	Washer	RE8	2	RE8	2
20	Foot / Support	9059	1	9059	1
21	Blade / Fixed	9592	1	9592	1
22	Bolt	VTCEI11	2	VTCEI11	2
23	Flange	9222	1	9222	1
24	Gasket *	8094	1	8094	1
25	Bolt / Stud	VP25	8	VP25	8
26	Nut	DEA16	8	DEA16	8
27	Washer	RE16	8	RE16	8
28	Shaft	9566	1	9566	1
29	Coupling / Dia. 18 – M16	9374	1	****	**
29	Coupling / Dia. 18 – M20	9053	1	9053	1
29	Coupling / Dia. 18 – M24	****	**	9054	1
29	Coupling / Dia. 18 – M24	****	**	9634	1
30	Rollpin	NO114	1	NO114	1
31	Bushing / Chrome	9565	1	9565	1
32	Disc	9564	1	9564	1
33	Washer / Spring	NO115	2	NO115	2
34	Hub	9568	1	9568	1
35	Key	LI3	1	LI3	1
36	Ring	9055	1	9055	1
37	Blade / Rotating *	9591	1	9591	1
38	Bolt	VTCEI33	1	VTCEI33	1
39	Washer	RE5	1	RE5	1
40	Bearing *	9075	1	9075	1
41	Washer	9569	1	9569	1
42	Bolt	VTCEI11	1	VTCEI11	1
43	Washer	RE8	1	RE8	1

Place "RI" prefix before all part numbers before placing orders.

NOTE: See serial plate located on pump for ratio to indicate parts needed for POS 29.

It is useful to keep a stock of fast wearing parts on hand for quick repairs. Most recommended spare parts are marked by an asterisk (*) following part description.

1-800-Team ABI



Email abigausa@att.net
www.abi-irrigation.com



AgriBusiness International, Inc
P.O. Box 909
Villa Rica, Georgia 30180 USA
Ph. 770-459-4401 Fx. 770-459-6877