

# Rovatti SL4K100GA+T Series Pump

Itemized Part Listing

01/2003

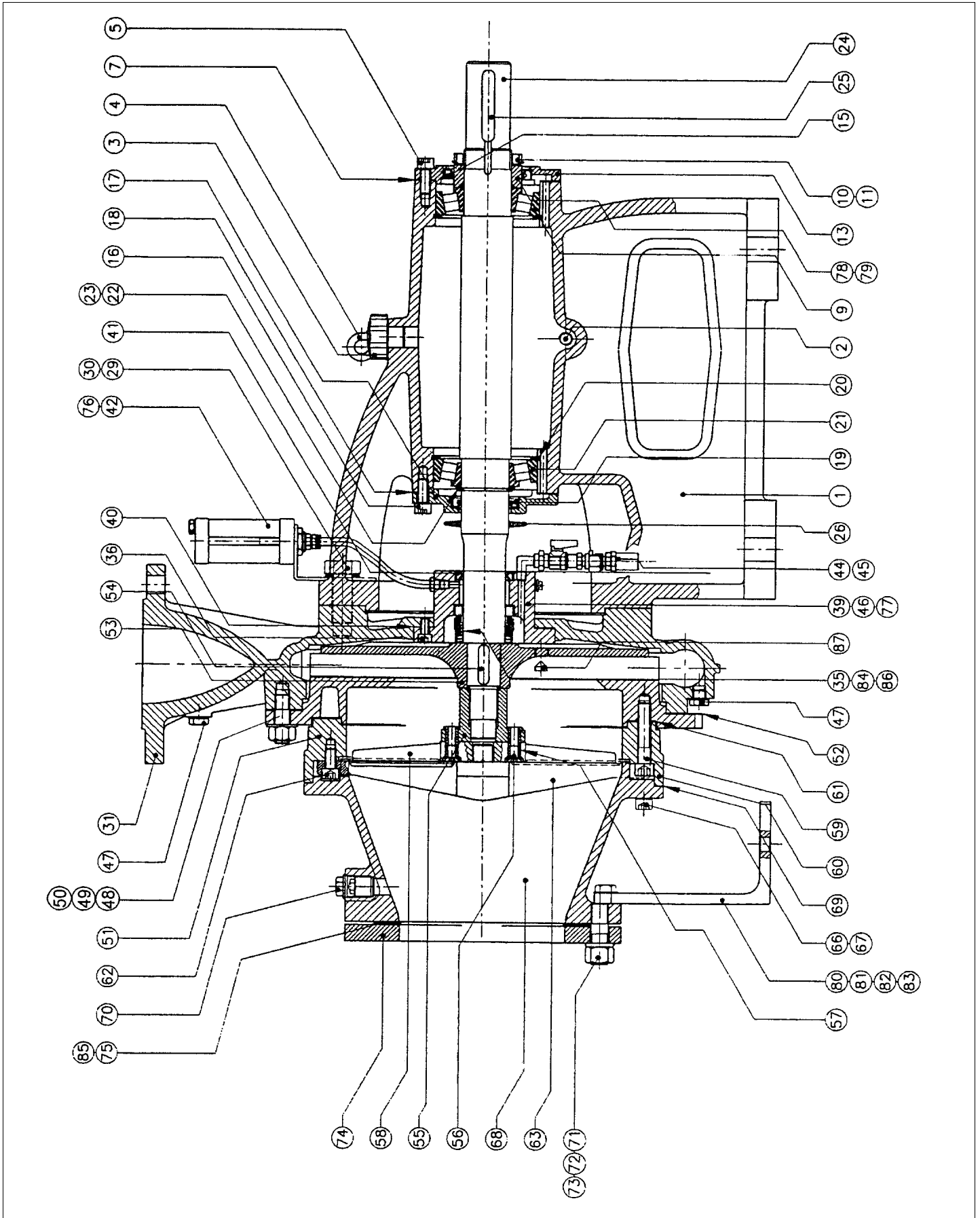

Place "RI" prefix before all part numbers before placing orders

POS	Item Description	SL4K100GA		SL4K100GA+T	
		Part #	Q	Part #	Q
1	Support / Bearing	4000	1	4000	1
2	Plug / Magnetic	4470	1	4470	1
3	Plug / Breather	3370	1	3370	1
4	Dipstick / Oil Level	3740	1	3740	1
5	Bolt	VTCEI2	4	VTCEI2	4
7	Gasket *	4008	1	4008	1
9	Bearing *	CU96	1	CU96	1
10	Nut / Ring	NO178	1	NO178	1
11	Rosette	NO179	1	NO179	1
13	Cover	12200	1	12200	1
15	Seal / Oil *	AT22	1	AT22	1
16	Bolt	VTCEI2	4	VTCEI2	4
17	Cover	4001	1	4001	1
18	Gasket *	4008	1	4008	1
19	Seal / Oil *	AT10	1	AT10	1
20	Circlip / Internal	AFI13	2	AFI13	2
21	Bearing *	CU96	1	CU96	1
22	Washer	RR4	1	RR4	1
23	Circlip / External	AFE7a	1	AFE7a	1
24	Shaft	12983	1	12983	1
25	Key	LI39	1	LI39	1
26	Ring / Water Sealing *	AP6	1	AP6	1
27	Support / Pump	12866	1	12866	1
28	Gasket *	4023	1	4023	1
29	Bolt	VTE74	4	VTE74	4
30	Washer	RE20	4	RE20	4
31	Body / Pump	12323	1	12323	1
32	Bolt / Stud	VTCEI12	10	VTCEI12	10
35	Seal / Mechanical *	TM40V	1	TM40V	1
35	Seal / Mechanical *	TM40L	1	TM40L	1
36	Bolt / Stud	VTCEI39	4	VTCEI39	4
39	Cover	12578	1	12578	1
40	Gasket *	12581	2	12581	2
41	Seal / Oil *	AT8	1	AT8	1
42	Oiler	12550	1	12550	1
44	Fitting	NO193	1	NO193	1
45	Kit / Mechanical Seal Flushing	13053	1	13053	1
46	Plug	NO140	1	NO140	1
47	Plug	NO19	2	NO19	2
51	Plate / Wear *	12456	1	12456	1
52	Gasket *	12246	2	12246	2
53	Impeller	12295	1	12295	1
54	Key	LI38	1	LI38	1
55	Nut / Impeller	DA27b	1	12902	1
56	Bolt	****	**	VTSP10	2
57	Pin	****	**	12903	2
58	Blade / Rotating Chopper *	****	**	12884	1
59	Bolt	VTCEI45	8	VTCEI45	8
60	Shell	12267	1	12267	1
61	Gasket *	12246	2	12246	2
62	Bolt	****	**	VTCEI23	2
63	Blade / Fixed Chopper *	****	**	12885	1
66	Bolt	VTCEI19	6	VTCEI19	6
67	Washer	RA2	6	RA2	6
68	Cone / Suction	12589	1	12589	1
69	Gasket *	12266	1	12266	1
70	Plug	NO14	1	NO14	1
71	Bolt / Stud	VP25	8	VP25	8
72	Nut	DEA16	8	DEA16	8
73	Washer	RE16	8	RE16	8
74	Flange	9222	1	9222	1
75	Gasket *	8094	1	8094	1
77	Rollpin	VCE7	1	VCE7	1
78	O-Ring *	OR57	1	OR57	1
79	Ring / Shoulder	12874	1	12874	1
80	Bolt	VTE4	2	VTE4	2
81	Washer	RB10z	2	RB10z	2
82	Washer	RE10	2	RE10	2
83	Foot / Support	12583	1	12583	1
84	Rollpin	VCE29	2	VCE29	2
86	Guard / Suction	9633	1	9633	1

It is useful to keep a stock of fast wearing parts on hand for quick repairs. Most recommended spare parts are marked by an asterisk (\*) following part description.

**1-800-Team ABI**



Email [abigausa@att.net](mailto:abigausa@att.net)  
[www.abi-irrigation.com](http://www.abi-irrigation.com)



sl4k100+t.pdf ABI 2002

**AgriBusiness International, Inc**  
P.O. Box 909  
Villa Rica, Georgia 30180 USA  
Ph. 770-459-4401 Fx. 770-459-6877